



Rama Homes

— Limited —



PROJECT DESCRIPTION

Rama Towers is an iconic, luxurious development strategically located along Wood Avenue in Kilimani .

This monumental masterpiece comprises of two twin towers, of purely office block.

The project is designed to ensure total privacy and security.

Indulge yourself every day in convenience and luxury at Rama Towers in Kilimani.



AMENITIES

- 24-HOUR SECURITY; COUPLED WITH ELECTRIC FENCING AND CCTV SURVEILLANCE.
- HIGH-SPEED LIFTS.
- BACK-UP GENERATOR.
- A WHOLE FLOOR DEDICATED FOR A FOOD COURT.
- AMPLE PARKING SPACES AND
- OTHERS TO CREATE A VIBRANT BLEND OF WORK SPACE AND UNPARALLELED LUXURY.



BENEFITS OF PURCHASING OFF-PLAN PROPERTY?



An investor gets to choose a suitable design & finishes for the property they are purchasing.



An investor is in a position to save up to 40% of the property value.



It allows the investor time to organise financially before & during the construction.



On hand over you get to be the first owner hence ensuring no defects.

WHY INVEST WITH US?



With us you get to enjoy a flexible payment plan of up to **10 years**.



Unlike other developers, we offer the payments at **0% Interest**.



All our developments have the necessary pre-approved licenses from the relevant institutions.



We guarantee client satisfaction by engaging the client from the onset.

ESSENTIAL INFORMATION

Project Type:

Commercial Office Block

Floor Area:

2800 MSQ

Floors:

30

Lifts:

Yes

Listed For:

Rent-To-Own



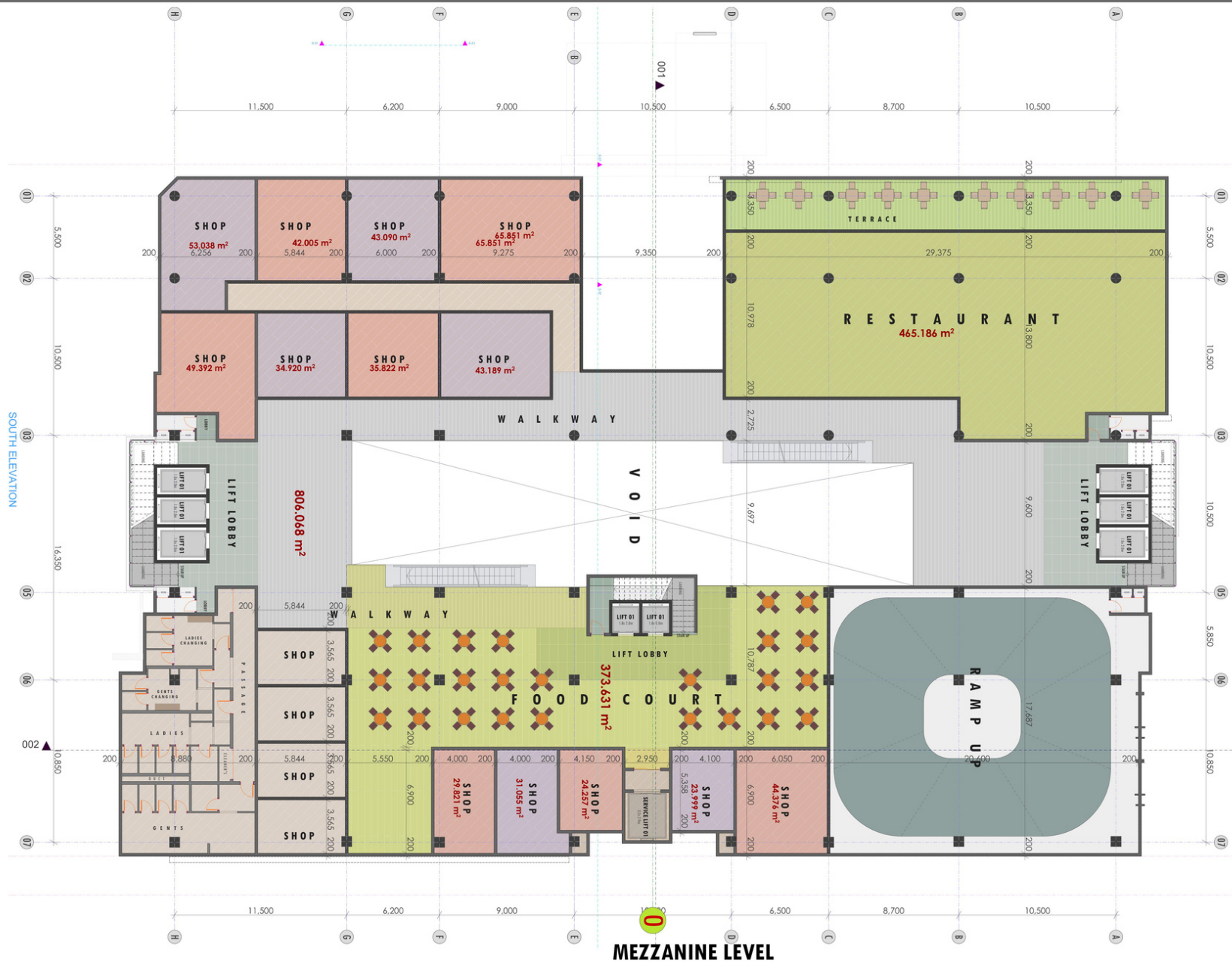

MEZZANINE LEVEL

CONSTRU CONSULTANTS LTD.
ARCHITECTS AND URBAN DESIGNERS
 P.O Box 42784 - 00200, NAIROBI. Tel. 2128213
 Email: Construconsultants@gmail.com
 Surveyors Court, Woodvale Groove Road,
 WESTLANDS

Project: **PROPOSED COMMERCIAL PROJECT**
 ON LR No. 1/160 - KILIMANI, NAIROBI.

Title: **FLOOR LAYOUTS/ SITE LAYOUT/SECTIONS**

Developer: **RAMA TOWERS**

| | | | |
|----------|--------------|-------------|----------------|
| DRAWN: | E. O. | DATE: | JUNE, 20 |
| CHECKED: | B.S.D | DRAWING No. | A[-]-JO |
| SCALE | 1:100, 1:200 | JOB No. | 2020/06-1 |

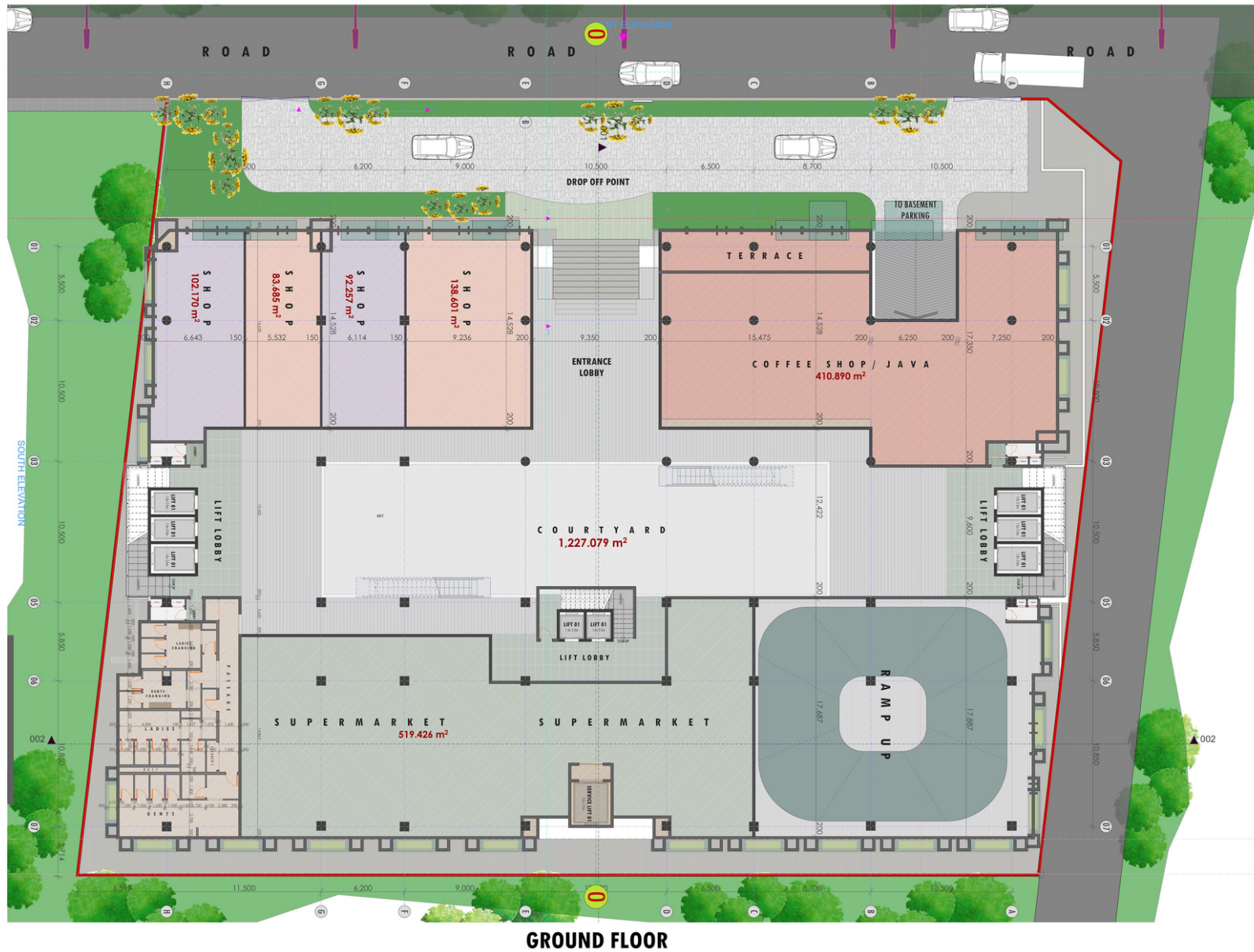

GROUND FLOOR

CONSTRU CONSULTANTS LTD.
ARCHITECTS AND URBAN DESIGNERS
 P.O Box 42784 - 00200, NAIROBI, Tel. 2128213
 Email: Construc consultants@gmail.com
 Surveyors Court, Woodvale Groove Road,
 WESTLANDS

Project: **PROPOSED COMMERCIAL PROJECT**
 ON LR No. 1/160 - KILIMANI, NAIROBI.

Title: **FLOOR LAYOUTS/ SITE LAYOUT/SECTIONS**

Developer: **RAMA TOWERS**

| | | | |
|----------|--------------|-------------|-----------------|
| DRAWN: | E. O. | DATE: | JUNE, 2020 |
| CHECKED: | B.S.D | DRAWING No. | A[-]-J01 |
| SCALE | 1:100, 1:200 | JOB No. | 2020/06-12 |



CONSTRU CONSULTANTS LTD.
ARCHITECTS AND URBAN DESIGNERS
 P.O Box 42784 - 00200, NAIROBI, Tel. 2128213
 Email: Construconsultants@gmail.com
 Surveyors Court, Woodvale Groove Road,
 WESTLANDS

Project: **PROPOSED COMMERCIAL PROJECT**
 ON LR No. 1/160 - KILIMANI, NAIROBI.

Title: **FLOOR LAYOUTS/ SITE LAYOUT/SECTIONS**

Developer: **RAMA TOWERS**

| | | | |
|----------|--------------|-------------|----------------|
| DRAWN: | E. O. | DATE: | JUNE, 2020 |
| CHECKED: | B.S.D | DRAWING No. | A[--]01 |
| SCALE | 1:100, 1:200 | JOB No. | 2020/06-12 |

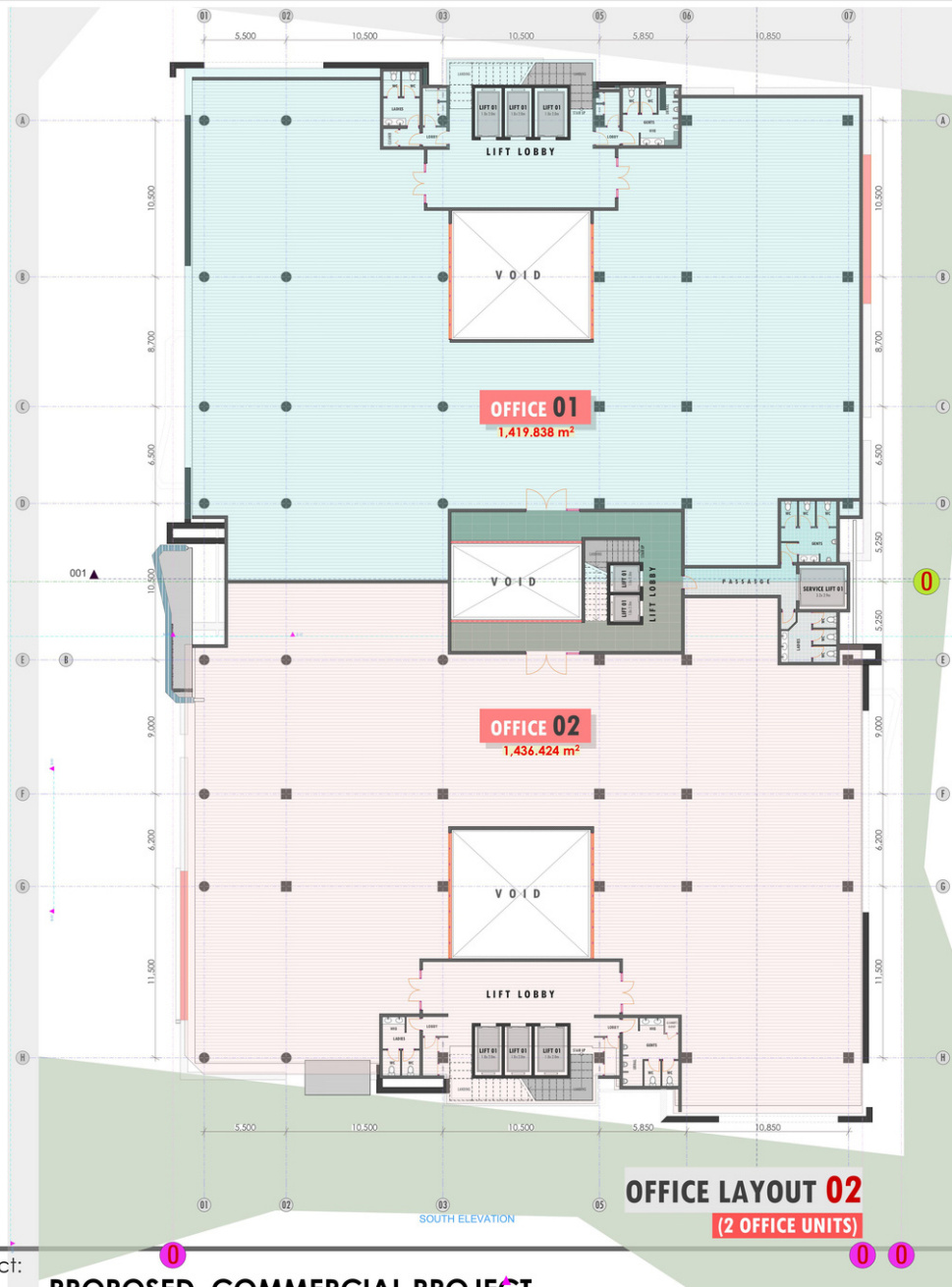

OFFICE LAYOUT 02
(2 OFFICE UNITS)

SOUTH ELEVATION

CONSTRU CONSULTANTS LTD.
ARCHITECTS AND URBAN DESIGNERS
P.O Box 42784 - 00200, NAIROBI, Tel. 2128213
Email: Construconsultants@gmail.com
Surveyors Court, Woodvale Groove Road,
WESTLANDS

Project: **PROPOSED COMMERCIAL PROJECT**
ON LR No. 1/160 - KILIMANI, NAIROBI.

Title: **FLOOR LAYOUTS/ SITE LAYOUT/SECTIONS**

Developer: **RAMA TOWERS**

| | |
|---------------------|----------------------------|
| DRAWN: E. O. | DATE: JUNE, 2020 |
| CHECKED: B.S.D | DRAWING No. A[--]01 |
| SCALE: 1:100, 1:200 | JOB No. 2020/06-12 |

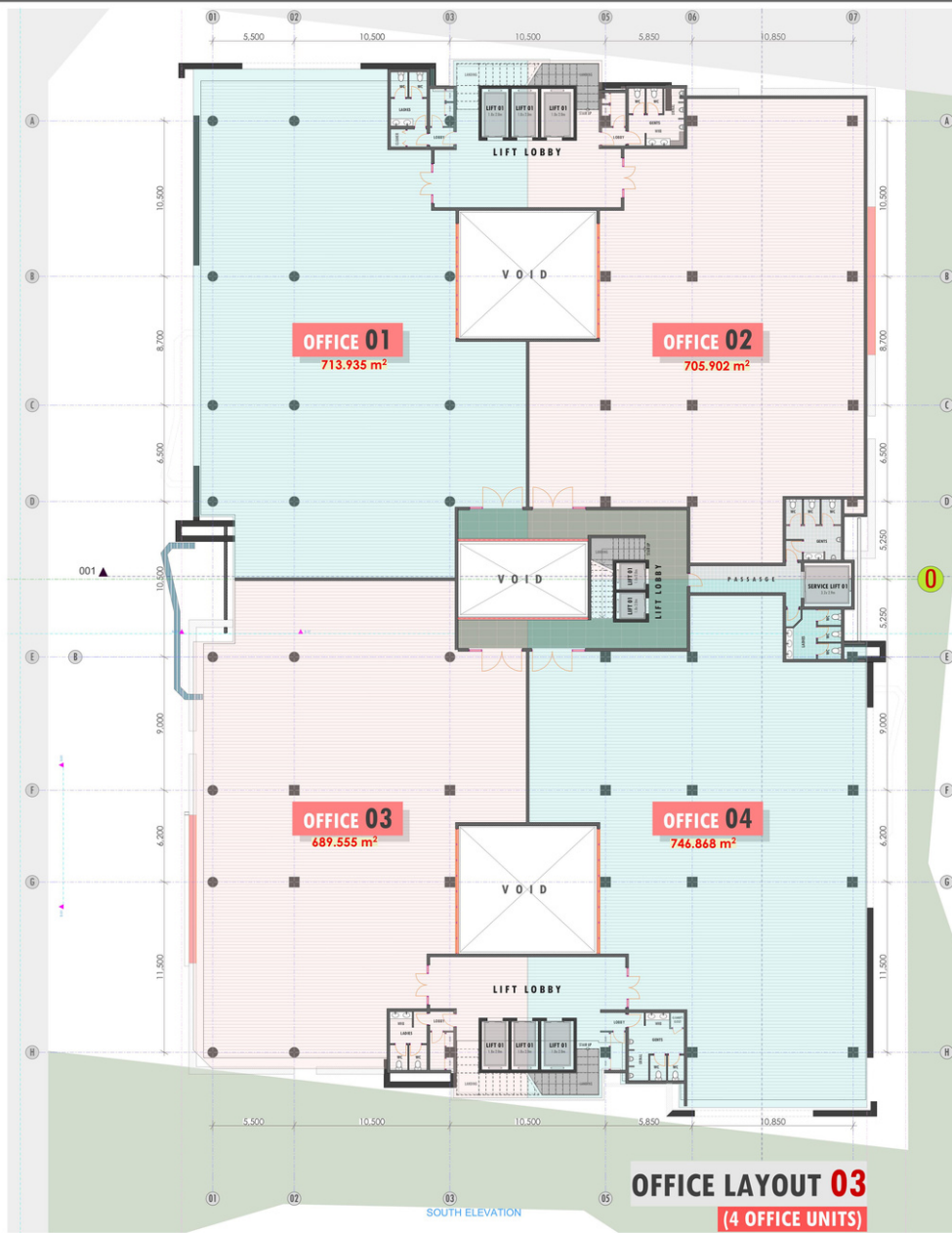

CONSTRU CONSULTANTS LTD.
ARCHITECTS AND URBAN DESIGNERS
P.O Box 42784 - 00200, NAIROBI, Tel. 2128213
Email: Construconsultants@gmail.com
Surveyors Court, Woodvale Groove Road,
WESTLANDS

Project: **PROPOSED COMMERCIAL PROJECT**
ON LR No. 1/160 - KILIMANI, NAIROBI.

Title: **FLOOR LAYOUTS/ SITE LAYOUT/SECTIONS**

Developer: **RAMA TOWERS**

| | | | |
|----------|--------------|-------------|-----------------|
| DRAWN: | E. O. | DATE: | JUNE, 2020 |
| CHECKED: | B.S.D | DRAWING No. | A[-]-J01 |
| SCALE | 1:100, 1:200 | JOB No. | 2020/06-12 |



OFFICE LAYOUT 04
(8 OFFICE UNITS)

CONSTRU CONSULTANTS LTD.
ARCHITECTS AND URBAN DESIGNERS
P.O Box 42784 - 00200, NAIROBI, Tel. 2128213
Email: Construconsultants@gmail.com
Surveyors Court, Woodvale Groove Road,
WESTLANDS

Project: **PROPOSED COMMERCIAL PROJECT**
ON LR No. 1/160 - KILIMANI, NAIROBI.

Title: **FLOOR LAYOUTS/ SITE LAYOUT/SECTIONS**

Developer: **RAMA TOWERS**

| | | | |
|----------|--------------|-------------|-----------------|
| DRAWN: | E. O. | DATE: | JUNE, 2020 |
| CHECKED: | B.S.D | DRAWING No. | A[-]-J01 |
| SCALE | 1:100, 1:200 | JOB No. | 2020/06-12 |



CONSTRU CONSULTANTS LTD.
ARCHITECTS AND URBAN DESIGNERS
 P.O Box 42784 - 00200, NAIROBI, Tel. 2128213
 Email: Construconsultants@gmail.com
 Surveyors Court, Woodvale Groove Road,
 WESTLANDS

Project:

PROPOSED COMMERCIAL PROJECT
 ON LR No. 1/160 - KILIMANI, NAIROBI.

Title:

**FLOOR LAYOUTS/ SITE
 LAYOUT/SECTIONS**

Developer:

RAMA TOWERS

DRAWN:

E. O.

DATE:

JUNE, 2020

CHECKED:

B.S.D

DRAWING No.

A[--]01

SCALE

1:100, 1:200

JOB No.

2020/06-12



5th Floor, Westpoint Plaza, Mpaka Road

0709658000

www.ramahomesltd.com